

2300 BI-FOLD INSTALLATION GUIDE

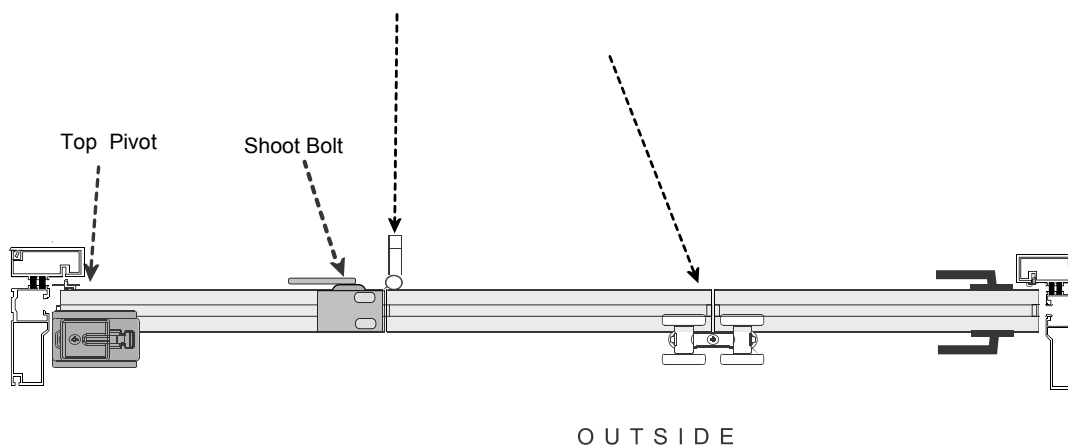

E3 HARDWARE PLACEMENT 3 Left OUT SWING

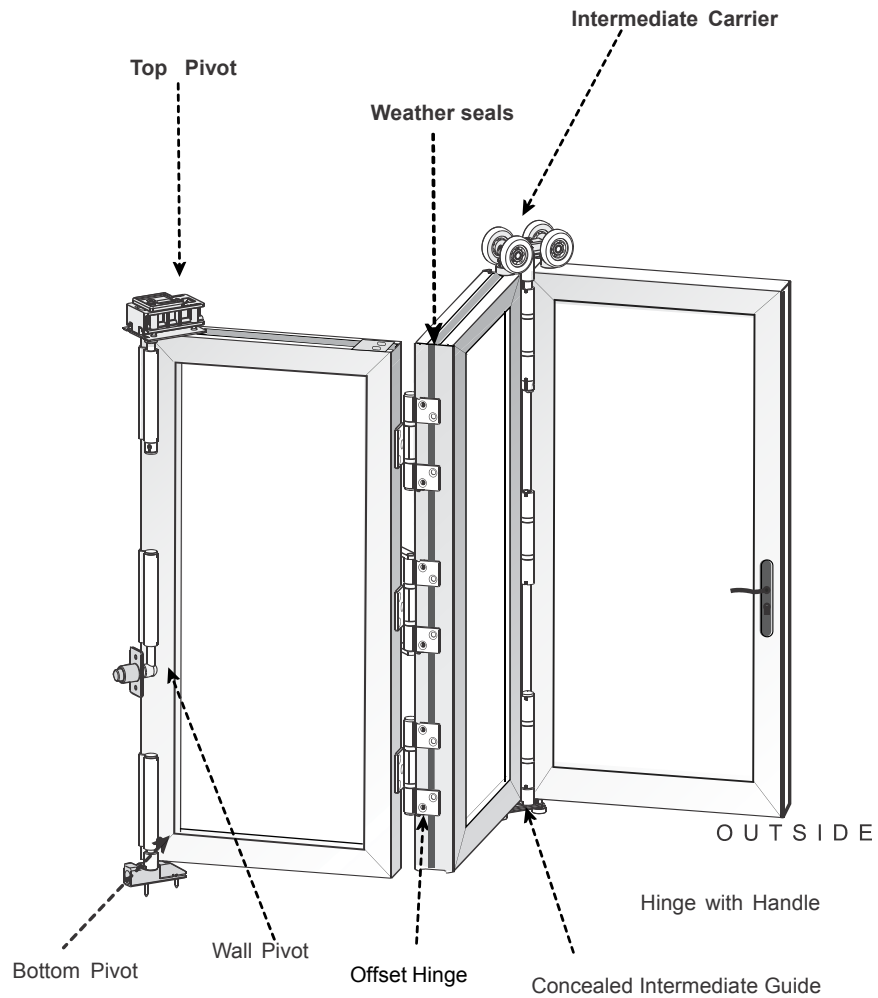

Cutaway of 3 panel bi-fold door
that closes into the jamb

E3 HARDWARE PLACEMENT 3 RIGHT IN SWING

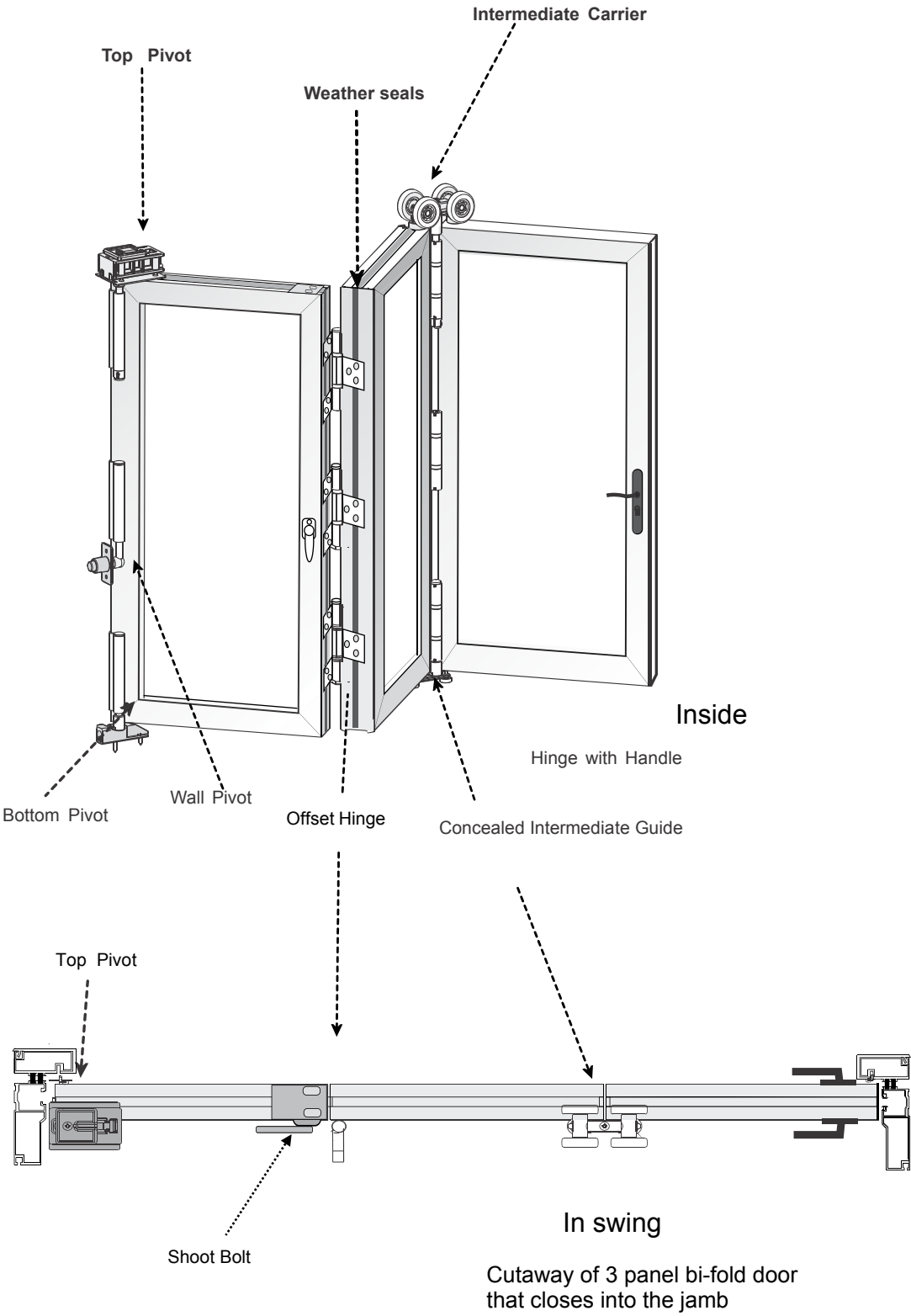

INSTALLATION INSTRUCTIONS OF MAIN FRAME

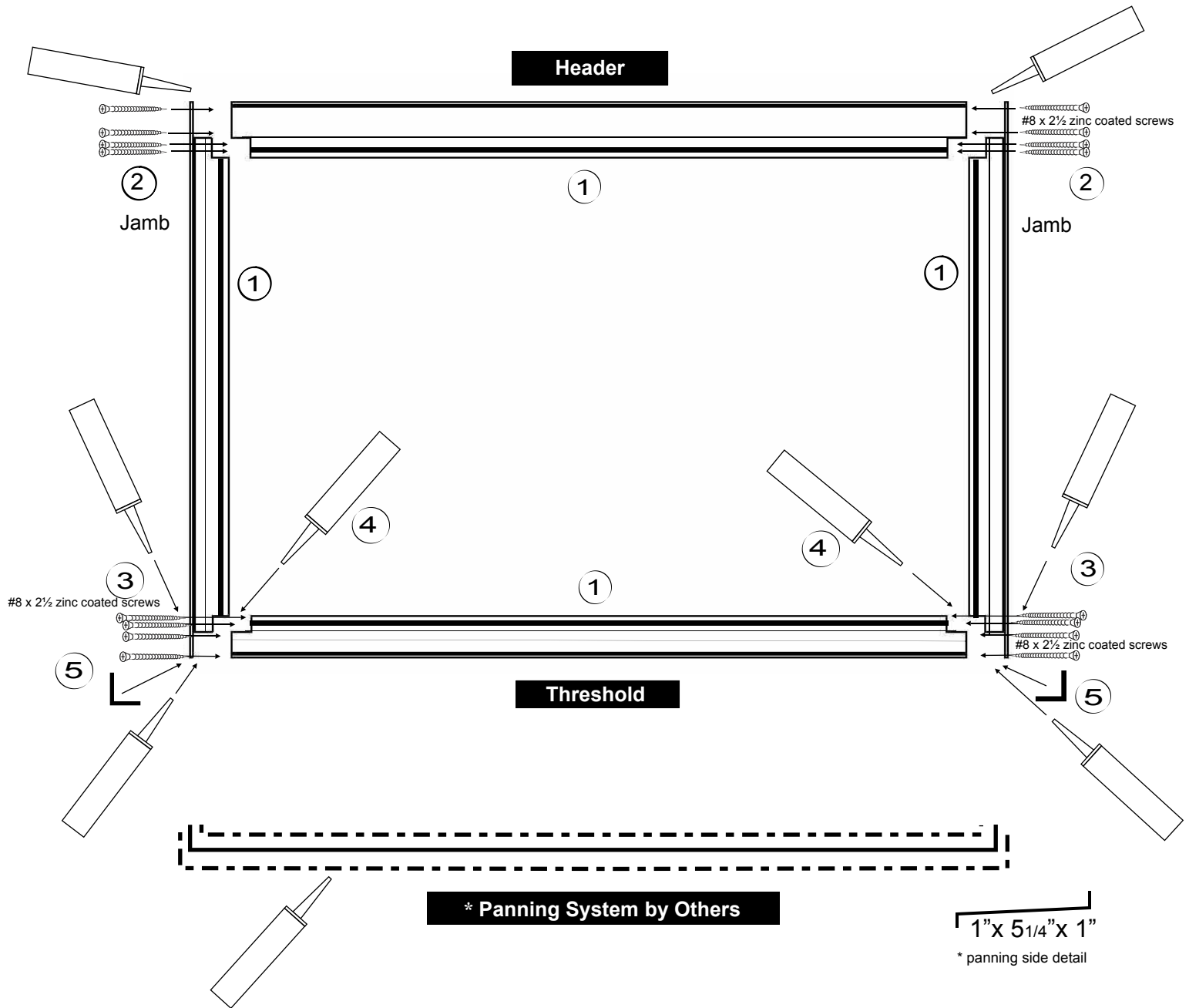

Frame Assembly

1. Lay out the main frame parts on a clean or cardboard covered level floor, the wider flat side should be facing down.
2. Starting with the header and side jambs apply seam sealer that is supplied to corners before inserting the #8 x 2 1/2 zinc screws one at a time as illustrated in the above drawing make sure the installer does not over tighten the screws.
3. Before the installer starts fastening the jambs to the threshold, apply liberal amounts of seam sealer (which is supplied) to the area that is to be fastened together.
4. After the frame is put together reapply the seam sealer into the Jamb /Threshold corner, don't use it sparingly. **(Remember water is not your friend)** . Make sure to fill all voids
5. There are **two PVC corner brackets measuring 2" x 2" x 5"**, they need to be applied to the bottom corners as in the illustration above, again using the seam sealer as in #4.

FRAME INSTALLATION INSTRUCTIONS

Center of frame should be $\frac{3}{16}$ " higher than jamb sides for header sag.

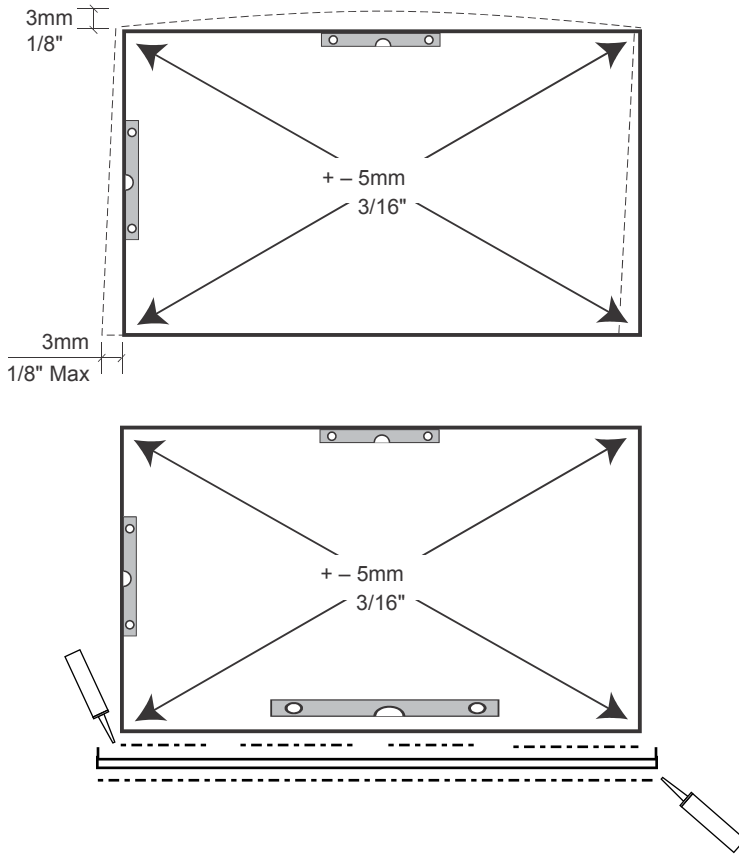

* Panning system recommended by Manufacturer in accordance with A.A.M.A. Installation Guide Lines.
Sealing pan to substrate / threshold to pan should always be in accordance to A.A.M.A. Installation Guide Lines.

Example of New Construction with block Frame

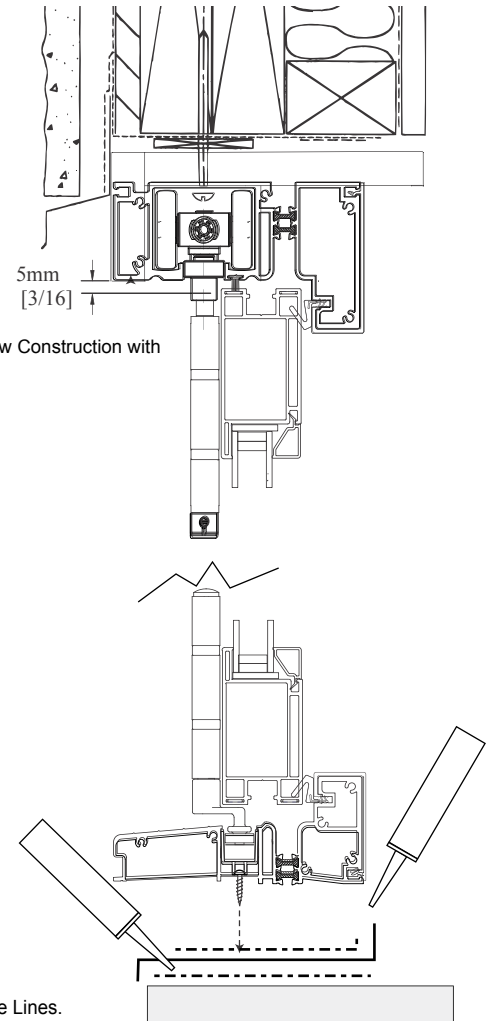

INSTALL FRAME

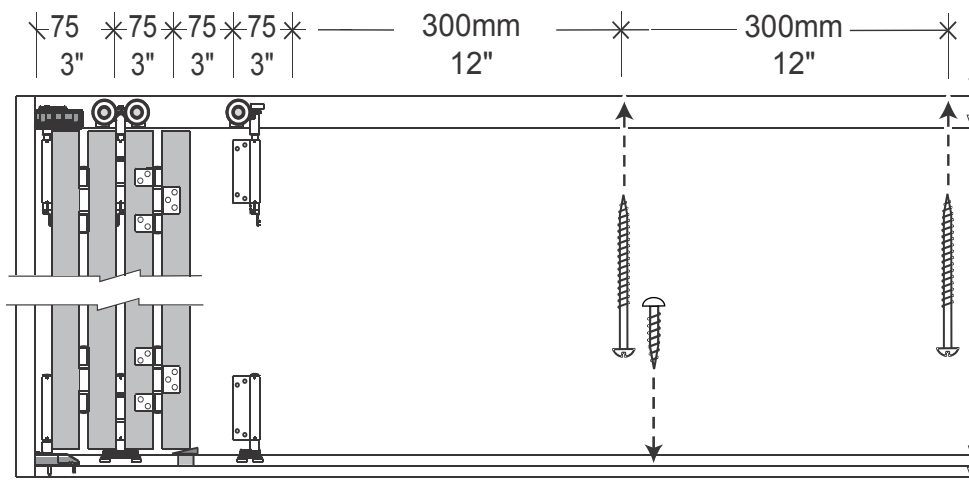

* Note: When penetrating the sill pan flashing with fasteners, pre-drill the holes, apply sealant into cleaned out hole, attach the fastener then seal over fastener heads with appropriate sealant. (Fasteners not supplied for header or sill).

Example of New Construction with Nail Fin

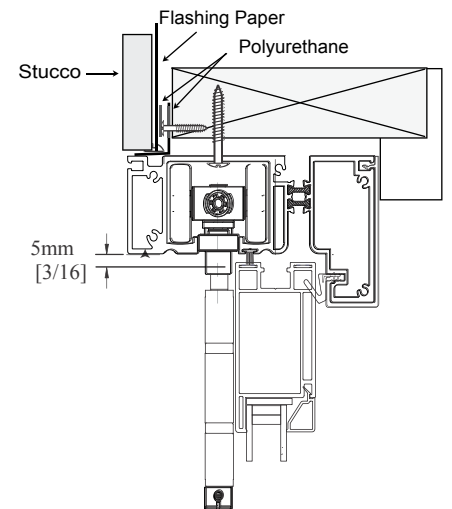

HINGES

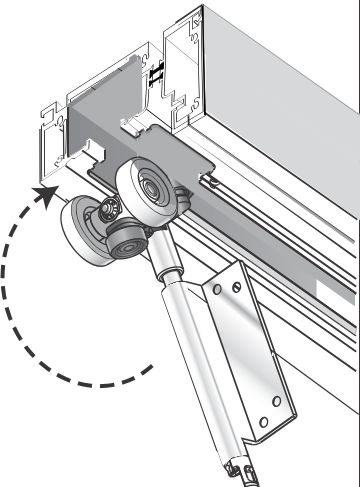
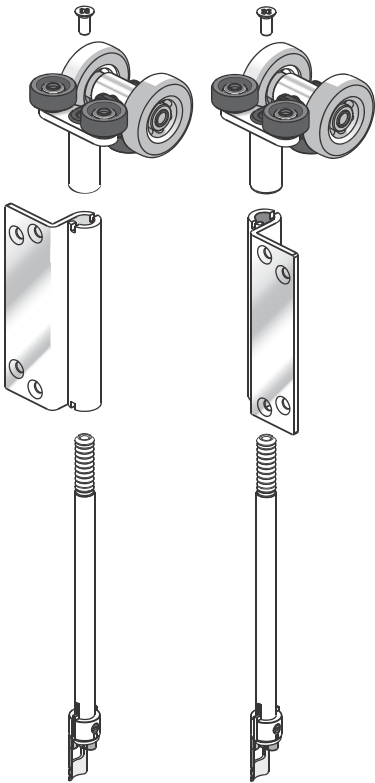

IMPORTANT
THOROUGHLY CLEAN
INSIDE OF TOP TRACK
BEFORE INSTALLING ROLLERS

ASSEMBLY - REVERSIBLE

INSTALLATION

CARRIERS AND GUIDES

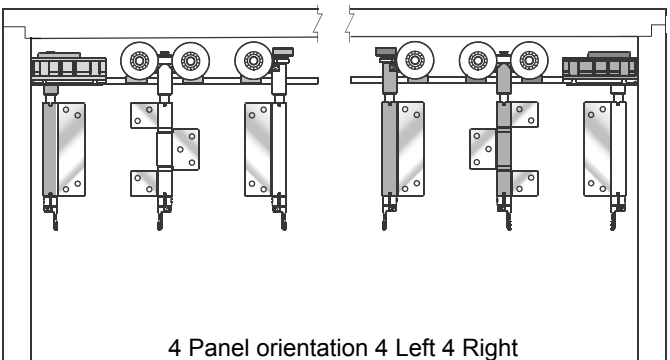

4 Panel orientation 4 Left 4 Right

HARDWARE ORIENTATION

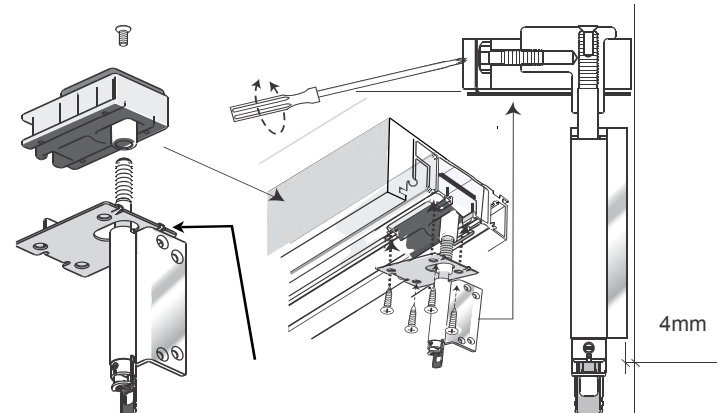

Top Pivot Block is installed in one piece

TOP PIVOT BLOCK



BOTTOM PIVOT BLOCK

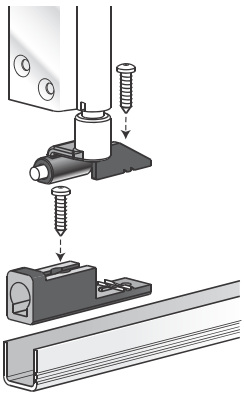

* Pre drill hole for pivot block, apply sealant before fastening screw.

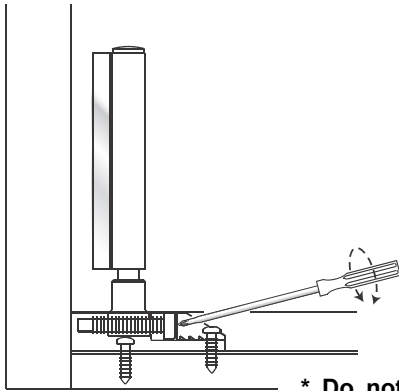

FITTING PIVOT PANEL

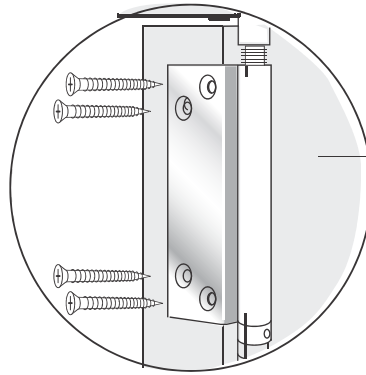

* Do not use the 1½" wood screws that are provided in the hinge boxes. Use the waxed # 10 x 1" stainless hinge screws supplied by Win-Dor.

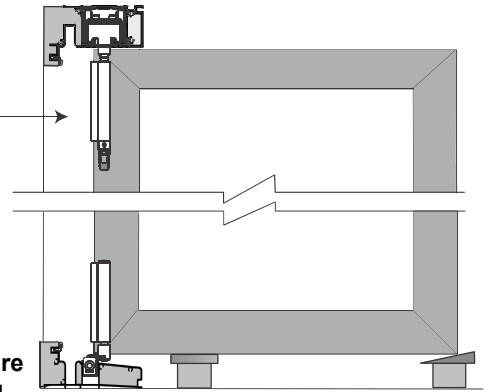

* Read Before Removing Center Alignment Screw for All Panels

* Each panel comes with a *Philips head alignment screw* that is attached where the center hinge will go, it is there to keep the predrilled holes aligned when attaching the hinges, Start panel installation with the top hinge first, once the hinge is installed you can remove the guide screw.

Philips Head
Guide Screw

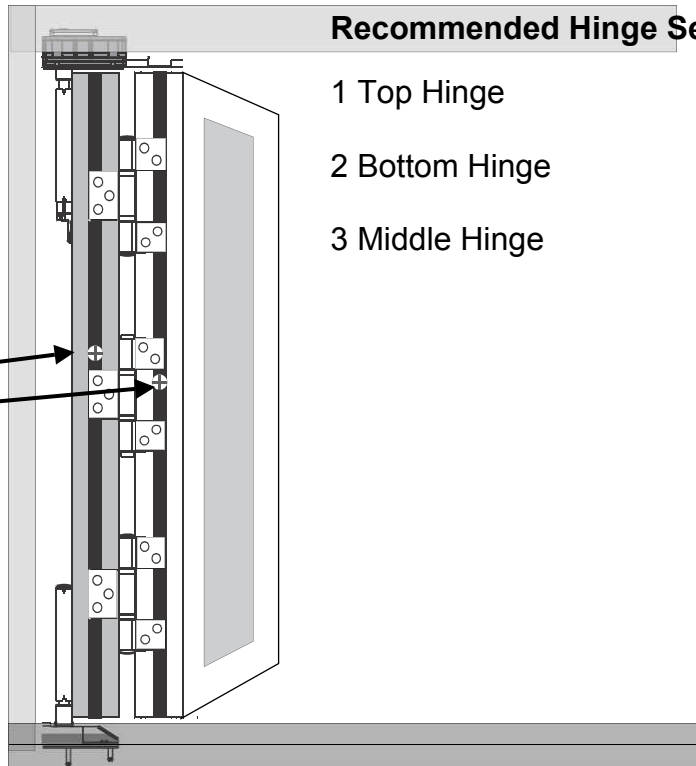

Recommended Hinge Sequence

- 1 Top Hinge
- 2 Bottom Hinge
- 3 Middle Hinge

Panel Adjustment

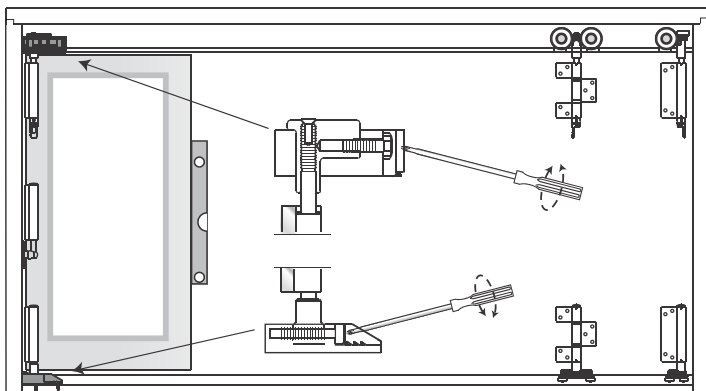

ADDING PANELS Panel are Numbered Left to Right From the outside

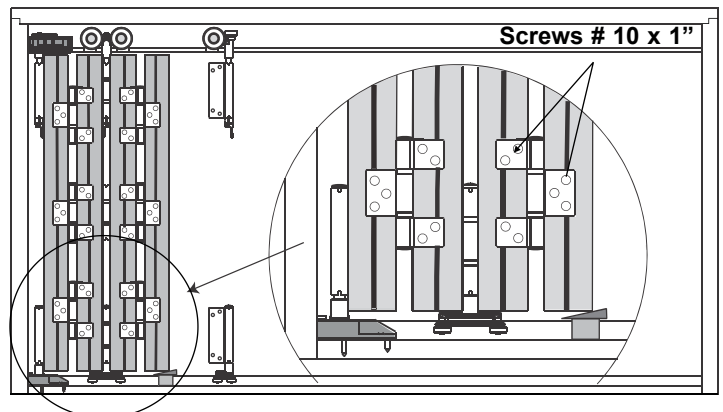

Screws # 10 x 1"

Even Panel One Way Left or Right Install and Adjustment

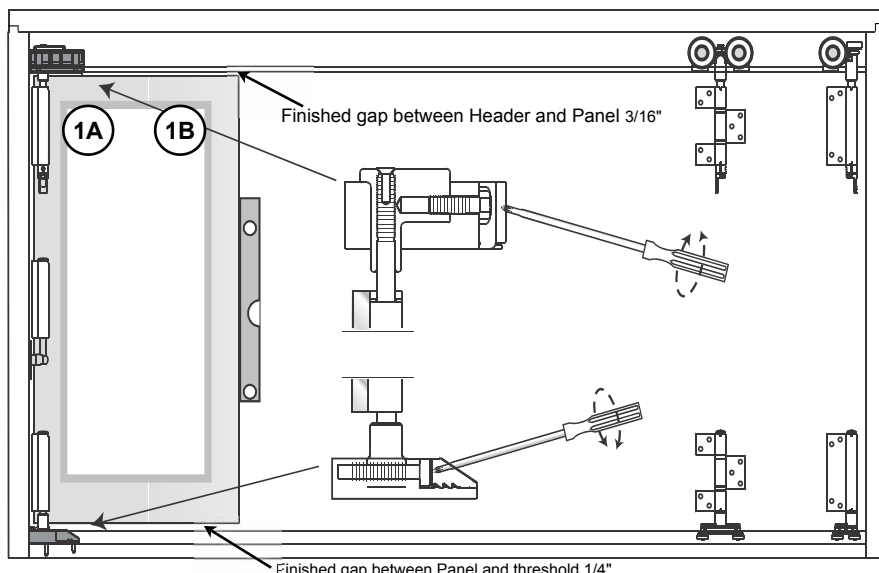

PANEL ADJUSTMENT

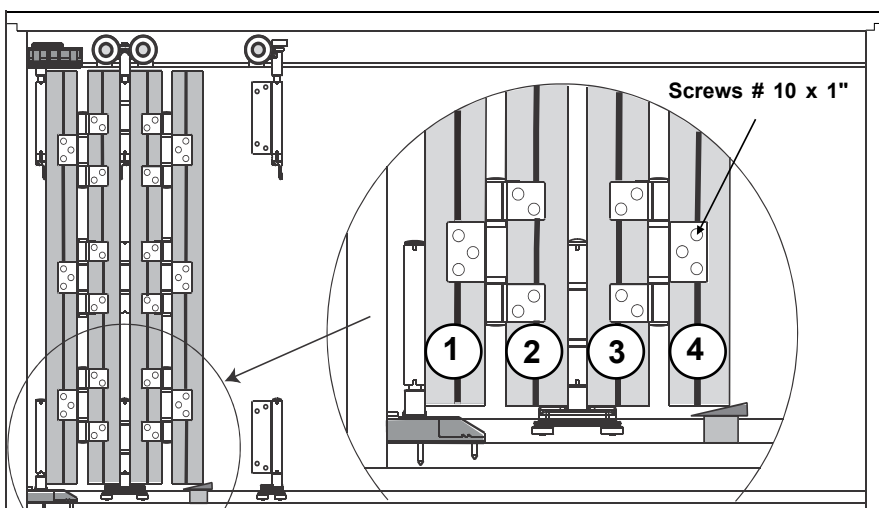

ADDING PANELS

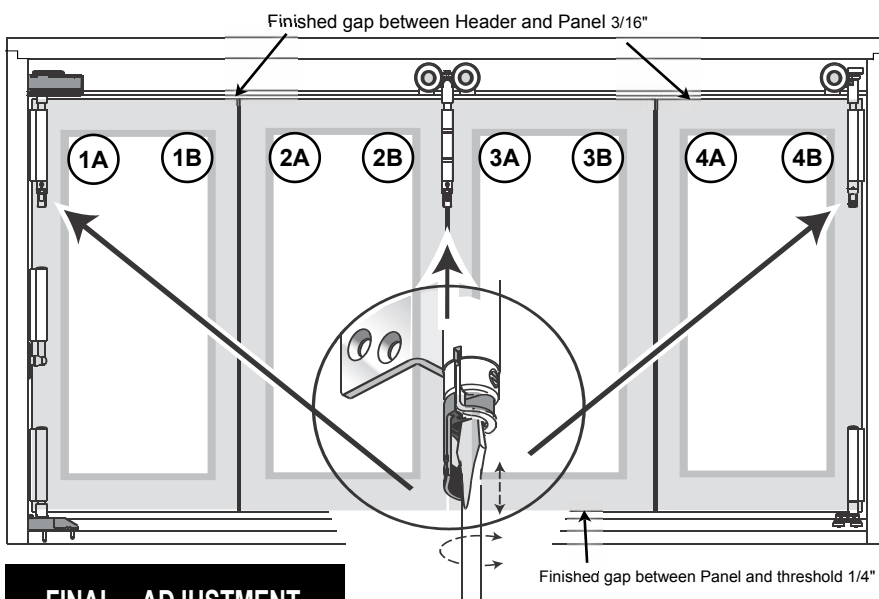

FINAL ADJUSTMENT

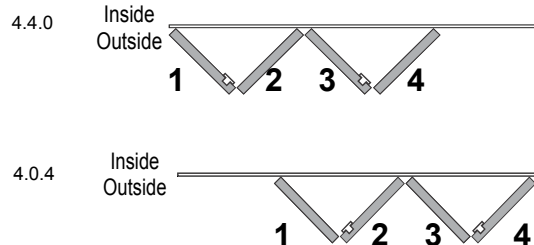

Panel numbering is always left to right

* After frame is installed correctly. Always start from with the pivot side first. Do not open Hardware box's arbitrarily you will mix hardware up.

*** Do not use the 1½" screws that are provided in the Centor boxes. Use only the 1" waxed screws that are provided.**

FINAL ADJUSTMENT

SURE LOCK ADJUSTMENT

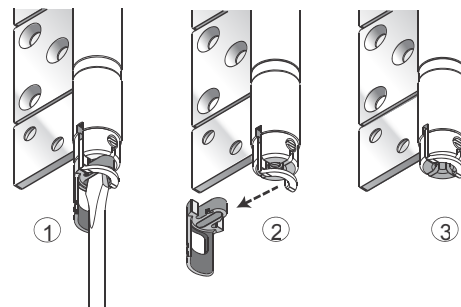

Surelock™ is the trademark for Centor's carrier pin locking system (patents granted).

Carrier pins at the top pivots, intermediate and end carriers support the full door weight and it is here that the height of the panels is adjusted. Surelock™ ensures that once the heights are set, they stay set.

Using Surelock™ is simple:

1. Surelock™ is supplied with a plastic clip installed to make initial adjustment very easy.
2. Insert a flat bladed screwdriver into the slot to rotate the pin.
3. When correct adjustment is reached and doors operate well, remove the shipping clip.
4. Surelock™ will automatically snap into place when the blade and slot are aligned.
5. To readjust at a later date, simply pull the blade down to disengage it from the slot and rotate the pin.

Example of Hardware Placement and Panel Numbering

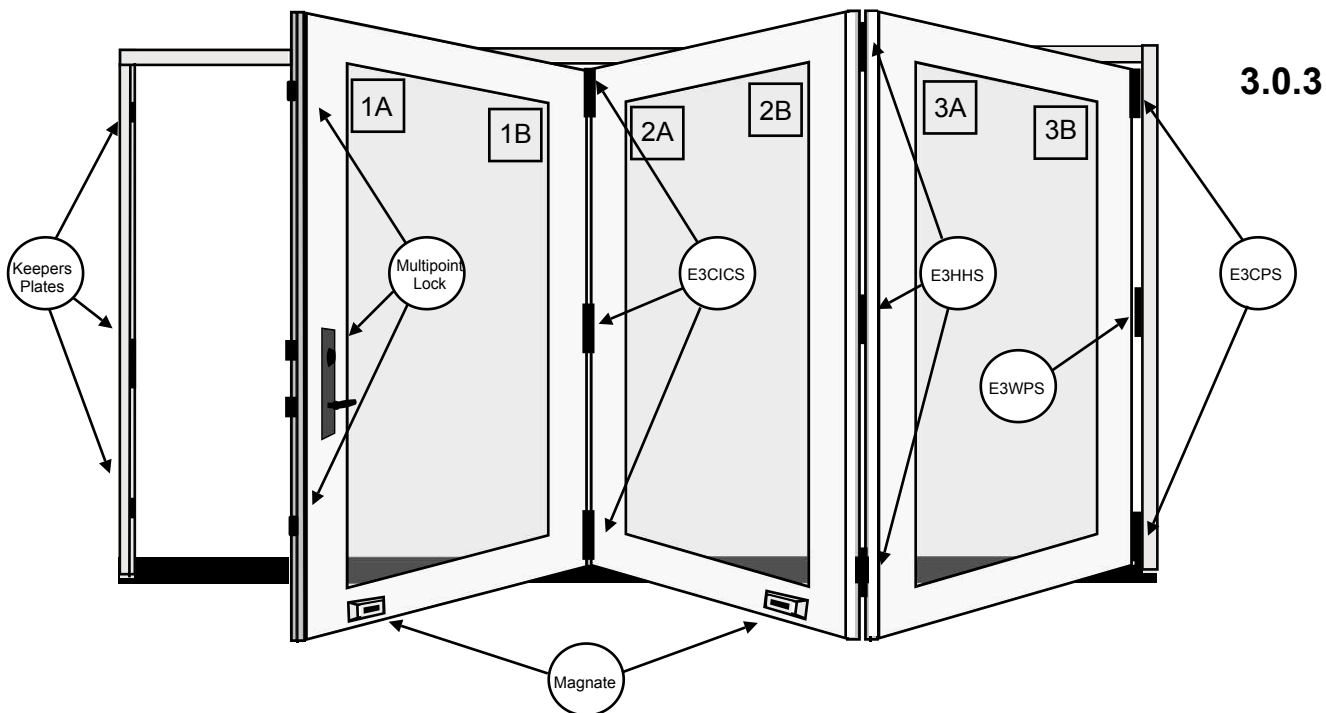

- 1 x E3 CPS Pivot Set
- 1 x E3 CICS Intermediate Carrier Set
- 1 x E3 HHS Half Offset Hinge Set
- 1 x E3 WPS Middle Wall Pivot
- 1 x DB Non-Keyed Flush bolt in Sash
- 2 x Centor Magnets

5.0.5 with 9'0" Height

* Always Looking From Outside In

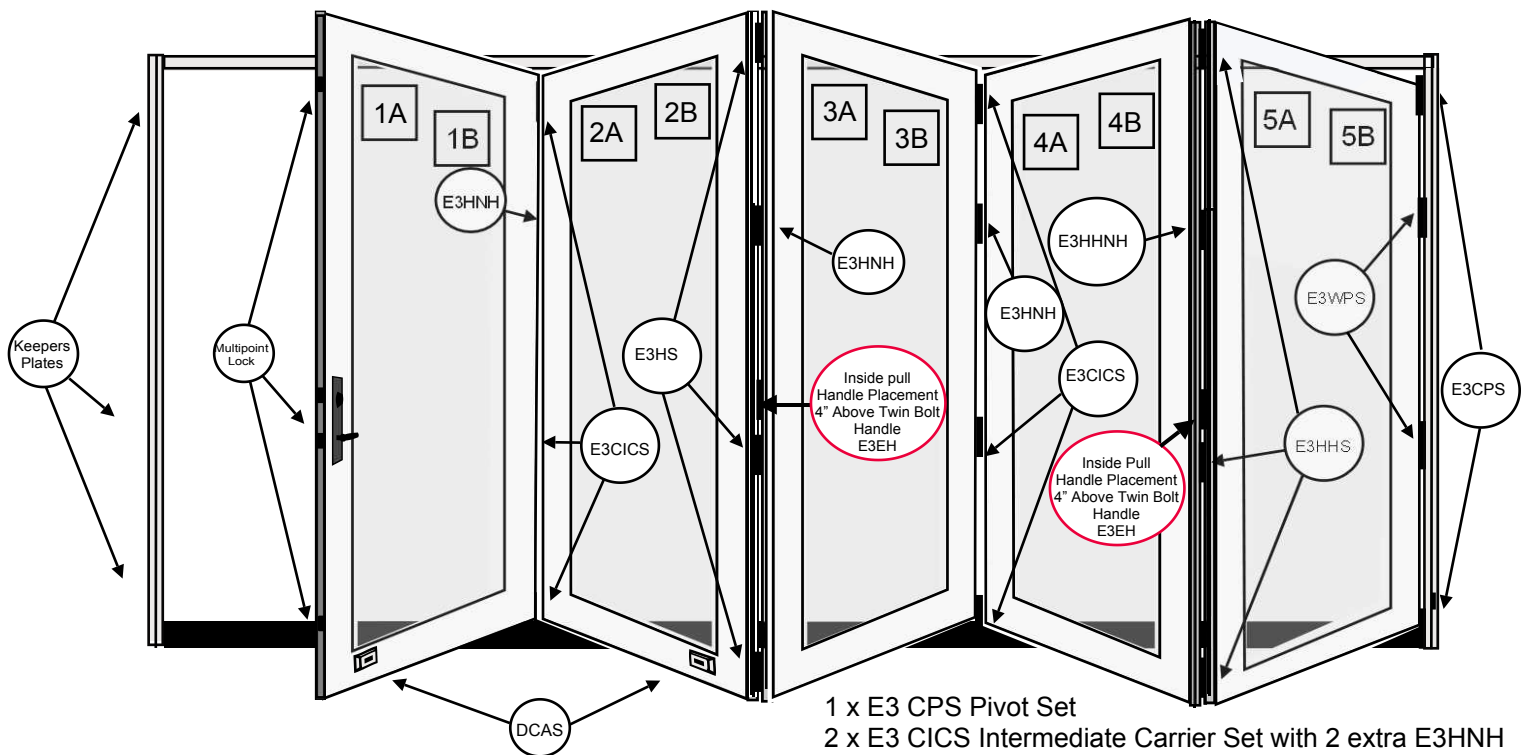

- 1 x E3 CPS Pivot Set
 - 2 x E3 CICS Intermediate Carrier Set with 2 extra E3HNNH
 - 2 x E3 HHS Half Offset Hinge Set with 2 extra E3HNNH
 - 2 x E3 WPS Middle Wall Pivot
 - 2 x DB Non-Keyed Flush bolt in Sash
 - 2 x E3 EH * Place Handle 4" above Twin Bolt Handle
 - 1 x DCAS Magnetic Catch
- Pull Handle to be field installed not Predrilled**

Astragal and Intermediate Carrier Assembly Installation

- A Sash has predrilled holes and machined slot for the intermediate carrier.
- B Fasten Intermediate carrier to slotted sash with screws that are provided.
- C Before applying the astragal to the sash panel make sure your sash is adjusted properly. Once the adjustment is made dry fit the astragal over the edge of the sash making sure the slot on the astragal lines up with the carrier.
If the astragal seems close to the header or sill you can trim the astragal with a fine tooth chop saw (go slowly).
After the dry fit is complete you can remove the double sided tape and apply to the sash. After the tape is applied you can also fasten screws through the astragal into the sash.
- D After the keepers are screwed in place, take the caps that are provided to fill in the space between the keepers.

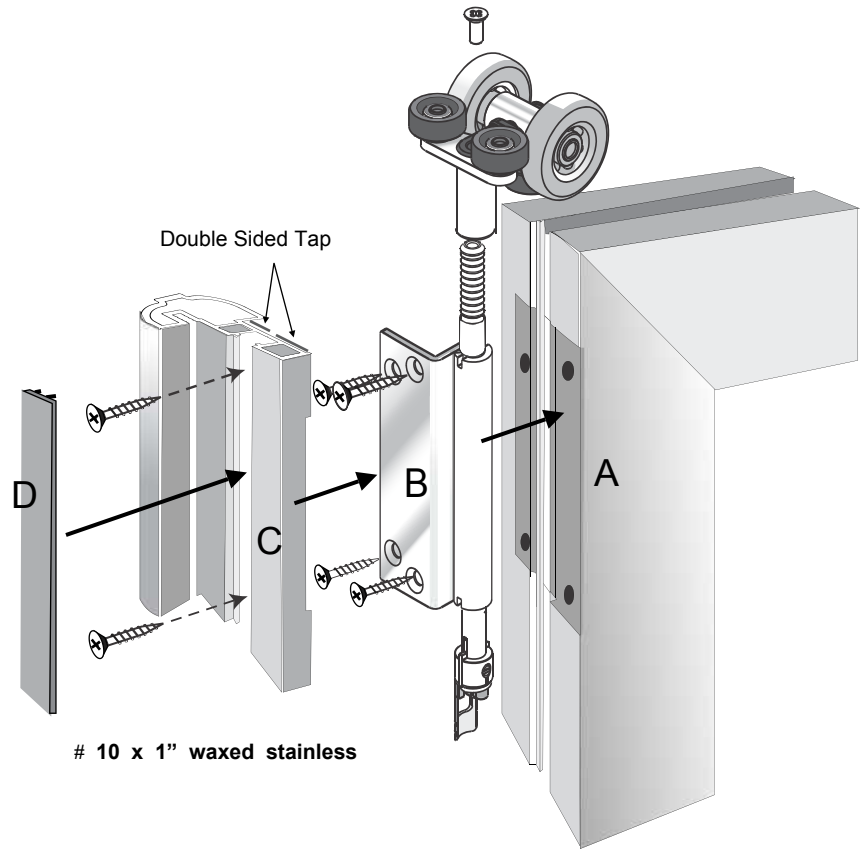

Cross Section of 2300 Series Bi-Fold

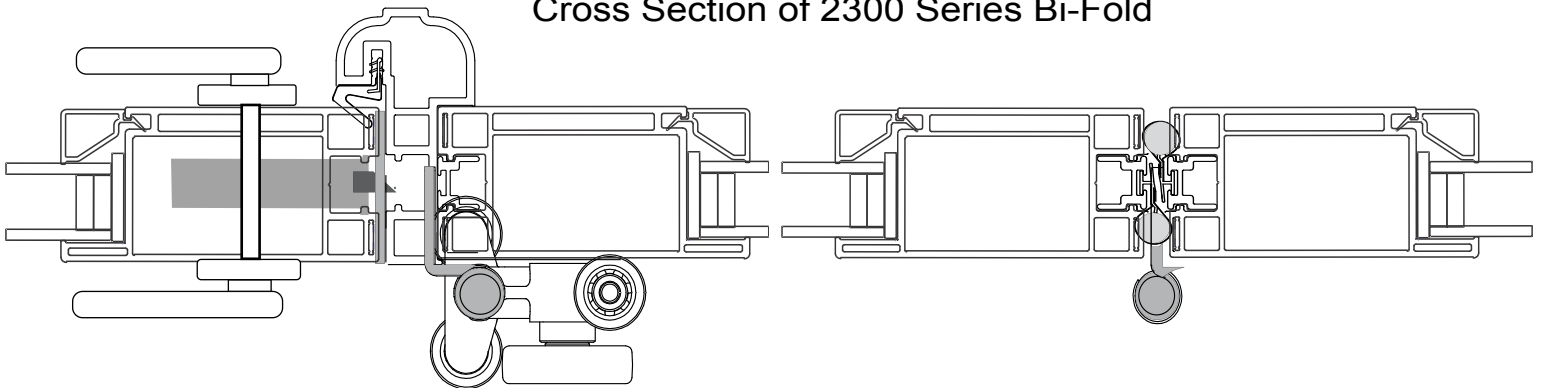

Double Astragal Example 1L 3 R

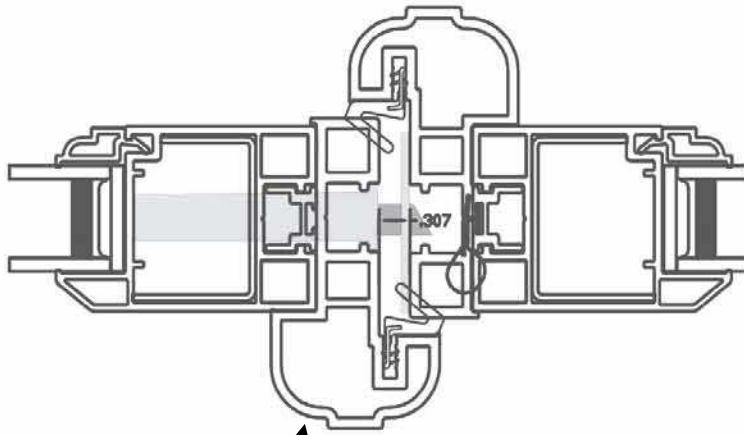

* Arrow pointing to a double french door style
Example shown is a 1L 3R

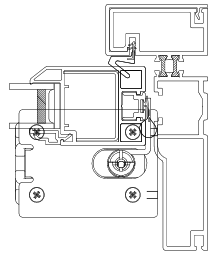
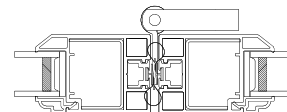
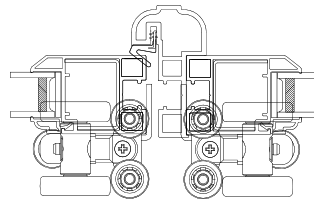
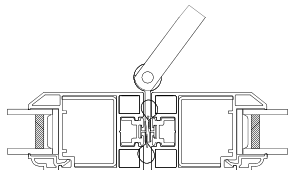
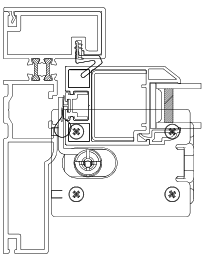
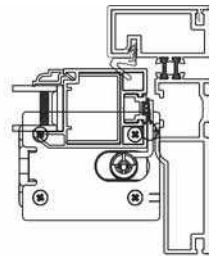
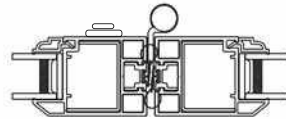
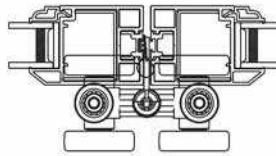
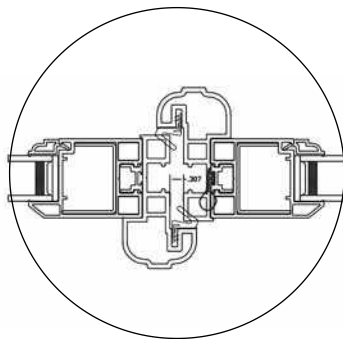
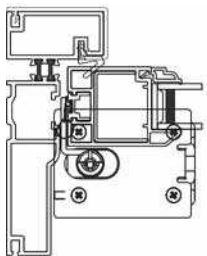

Single Astragal 2R 2L

Hardware Installation for French Doors and Bi-Fold Doors

SWINGING PATIO DOOR and BI-FOLD DOORS

A #2 Phillips Screwdriver is required.

A hex-wrench for set screws is provided in the hardware package.

To prevent damage to the handle set while in construction phase, use the construction handle to operate the door. Lift to engage multipoint after door is closed. Push down handle to open the door.

Use water to clean. Do not use brass cleaner. It will remove the protective coating.

NOTE: Handles and back plates vary in style. For proper operation, the hardware must be installed in the following order:

- 1 Apply the back plate gasket (8) to the inside of the exterior Back plate (1). Push gasket firmly onto plate to ensure a tight seal. Apply the back plate gasket (8) to the inside of the interior back plate (2). Apply interior (2) and exterior (1) back plates and fasten loosely with the two screws (6) provided. Note : The screw heads must be on the interior side of the door.
- 2 Insert the two piece handle shaft (3) into the handle. Be sure to orient the shaft (3) as shown. Screw the set screw until flush with handle using the allen wrench. See Figure 2. Note: This may seem to be a tight fit. Insert the handle attached to the shaft into the latch hole.
- 3 Install the interior handle on the shaft through the latch hole, pressing tightly to the back plates. Tighten the interior handle set screw with allen wrench. Screw until flush with handle.
- 4 Insert the keyed cylinder from the interior side of the door until it is flush with the exterior back plate. Install the cylinder screw (7) in the screw hole below the deadbolt in the edge of the door.
- 5 Tighten the back plate screws.
- 6 To change handing on latch bolt(circled in red), grip the top and bottom with a pair of pliers, pull out when it's free from the receiver rotate either left or right returning it back into the receiver.

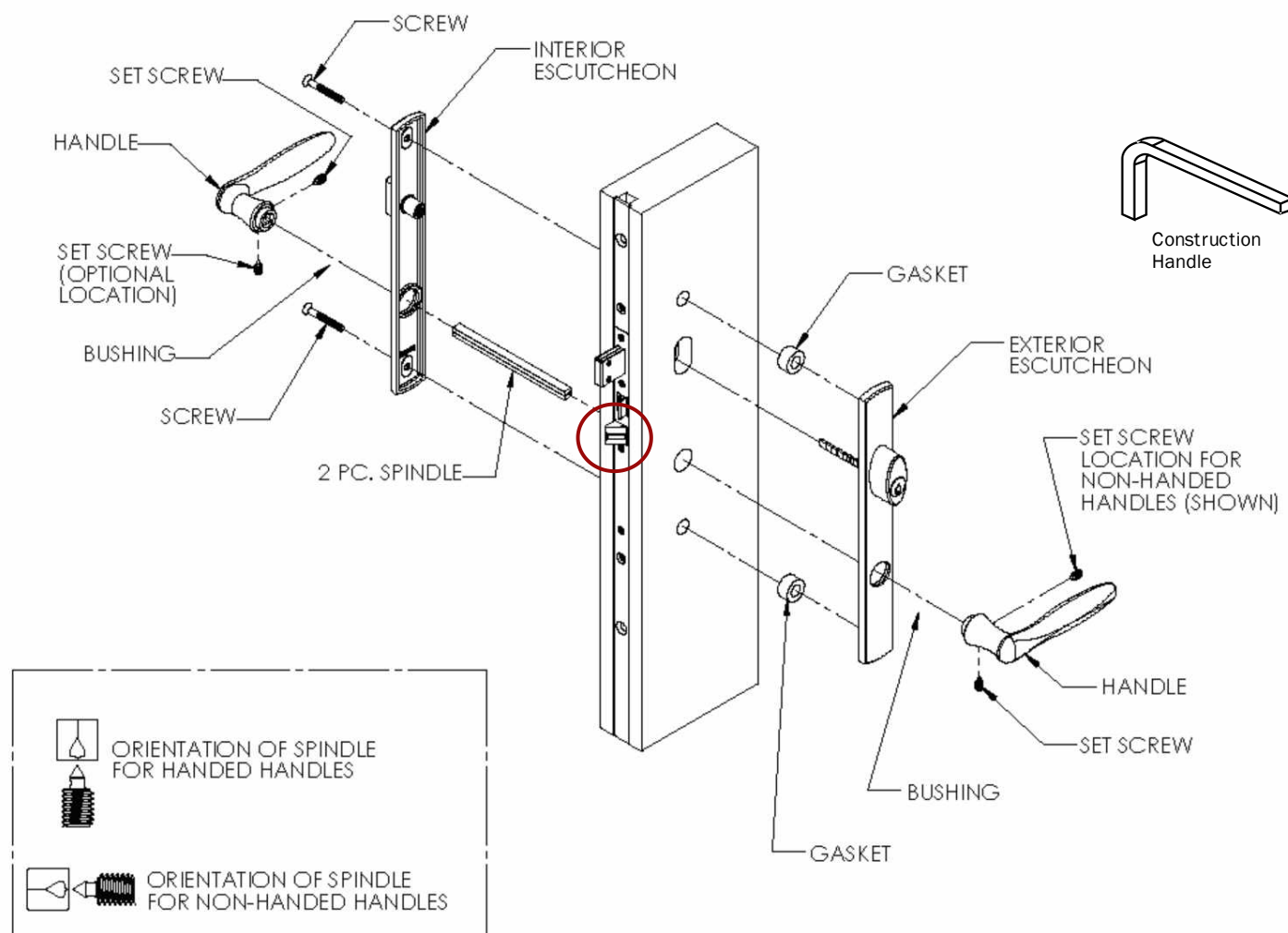

Bi-Fold Hinge Shim Installation

To make your bi-fold door installation easier, we have included hinge spacers *if needed*. The hinge spacer is an easy and reliable tool to help you overcome variations in sizing that can change in the welding process. *Before applying any hinge shims make sure all proper spacing and alignments have been made to your bi-fold door.*

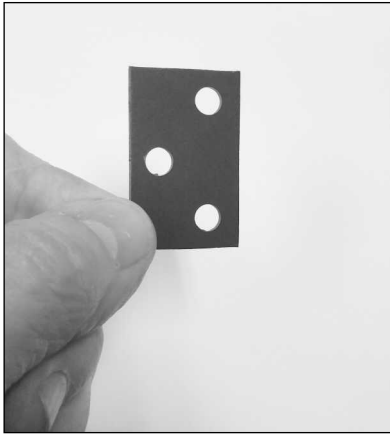

Hinge shim size is 15/8" x 13/16" x 1/16"
spacer comes in black only and can be
doubled up.



1. The hinge shim is designed, for the center
hinge leaf only. Make sure you shim all
the hinges on the same sash. Multiple
sash panels can be shimmed.



2. Remove the screws to the center
leaf. Be sure to do one hinge at a
time starting from the top.



3. Fold back the center leaf.



4. Remove the adhesive backing of the
hinge shim.



5. Use some care when lining up the
hinge shim and the center leaf.
Press the shim and the center leaf
together.



6. Fold back your center leaf and reinstall
the screws that were taken out.
Make sure not to over torque your
screws.